



SOLERA[®]
PULL STRAP AWNING
OWNER'S MANUAL

LIPPERT
COMPONENTS[®]

TABLE OF CONTENTS

Introduction	2
Safety	2
Operation	3
Extending the Awning	3
Retracting the Awning	4
Adjusting Pitch	5
Maintenance	5
Fabric Care	5
Troubleshooting	6
Solera Manual Awning, Pull Strap Assembly	7
Solera Manual Awning, Pull Strap Components	8-13

Introduction

The Solera® Manual Pull Strap Awning extends and retracts with the easy-to-use pull strap. This manual provides operational procedures for Solera Manual Pull Strap Awning. Solera Manual Pull Strap Awning features an internal spring system that extends and retracts the awning. Additionally, the friction joint allows for rain dump and adjustable pitch features, and there is no rafter arm to lock in place. The friction joint also provides added stability.

Safety



The "CAUTION" symbol above is a sign that a procedure has a safety risk involved and may cause personal injury or product and/or property damage if not performed safely and within the parameters set forth in this manual.



Moving parts can pinch, crush or cut. Keep clear and use caution.



Operating the Solera Manual Pull Strap Awning in any other manner than described may result in personal injury, damage to the recreational vehicle or the awning assembly as well as voiding the Lippert Components Limited Warranty.

Operation

Extending the Awning

1. Locate the locking latch (Fig. 1), if equipped, and unlock the latch (Fig. 2).

NOTE: This latch is optional and may or may not be installed on one or both support arms.

2. Using the pull rod, place the "L" end of the rod on top of the cam lock (Fig. 3A) and pull down on the lock to release it (Fig. 3).

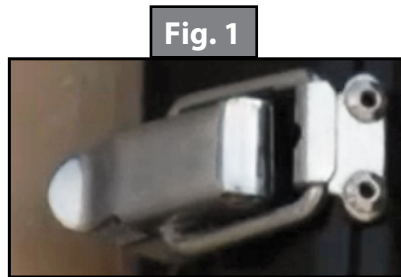

Fig. 1

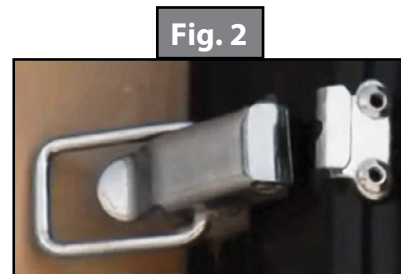

Fig. 2

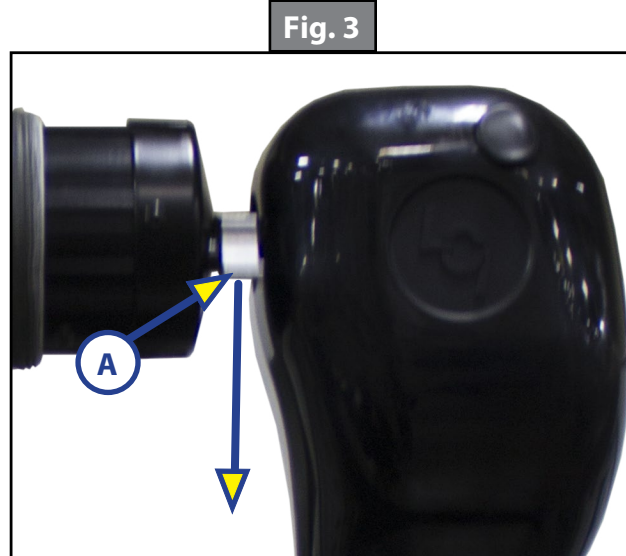

Fig. 3

3. Insert the pull rod into the pull strap (Fig. 4).
4. Pull strap to chest height using the pull rod. Using hands to grasp the strap, walk the awning outward, keeping in front of the roll tube at all times (Fig. 5).

NOTE: Extension is considered complete when the fabric is completely unrolled, the valance seam is visible and a section of the roll tube is exposed (Fig. 6). The exposed part of the roll tube will be under the awning upon full extension. Also, check to make sure the cam lock is on top of the roll tube.

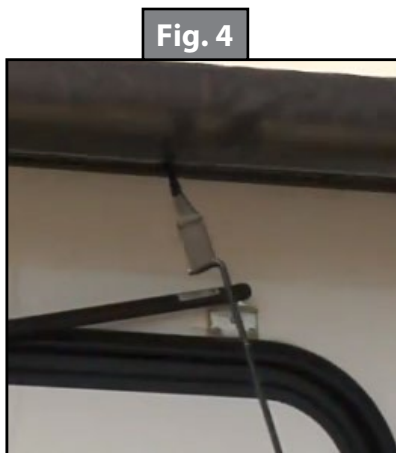

Fig. 4

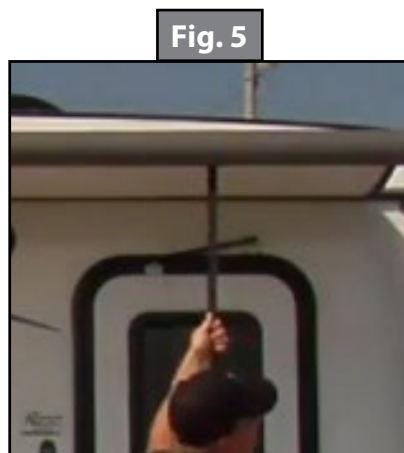

Fig. 5

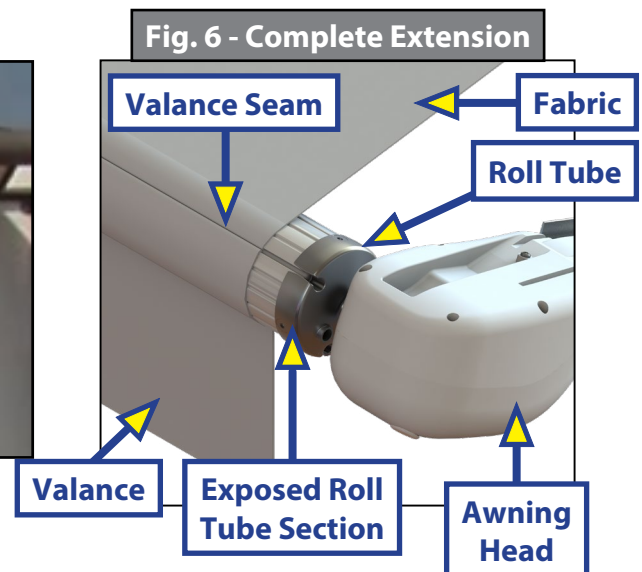

Fig. 6 - Complete Extension

CAUTION

Tying the roll tube down once extended will not allow the free floating support arms to work as designed and may cause damage to the awning or RV.

5. Do NOT tie down the roll tube, which would restrict proper support arm movement.

Retracting the Awning

NOTE: The awning can be retracted without resetting the pitch. See Adjusting Pitch section.

1. Grasp the strap and pull slightly to release pressure on the cam lock (Fig. 7A) and disengaging the cam lock.
2. While holding the strap in hand, walk the awning toward the unit until the strap is about chest height (Fig. 8).

Fig. 7

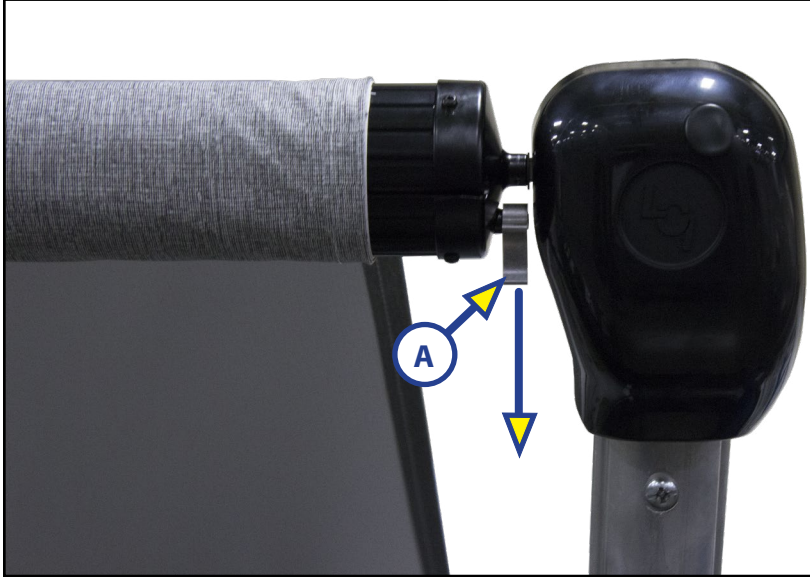

Fig. 8



3. Insert pull rod into the pull strap.
4. Walk awning all the way in until it stops (Figs. 9 and 10). Remove pull rod from strap.
5. Locate the locking latch (Fig. 11), if equipped. Lock the latch to secure the awning in place (Fig. 12).

NOTE: This latch is optional and may or may not be installed on one or both support arms. If not installed, awning is secured and ready for transportation.

Fig. 9



Fig. 10



Fig. 11



Fig. 12



Adjusting Pitch

1. Pitch can be set manually by adjusting the articulating arm to tip one side of the awning to allow water runoff.

NOTE: The awning will pitch itself to purge the pooling of excess water and may dump a significant amount of water without notice.

2. Extend the awning to desired position.
3. Choose the side of the awning for optimum shade or convenient water runoff. Pull downward on the joint of the articulating arm until desired pitch is set (Fig. 13). Do not push the articulating arm up past straight. This will put tension on the gas strut, which can cause the strut to break. Belleville washers and bolt (Fig. 14A) allow for the joint to remain in the set position.

NOTE: If the articulating arm does not hold position, it can be tightened by adjusting the bolt (Fig. 14A) in the center of the articulating arm.

NOTE: The awning can be retracted without resetting the pitch.

Fig. 13



Fig. 14

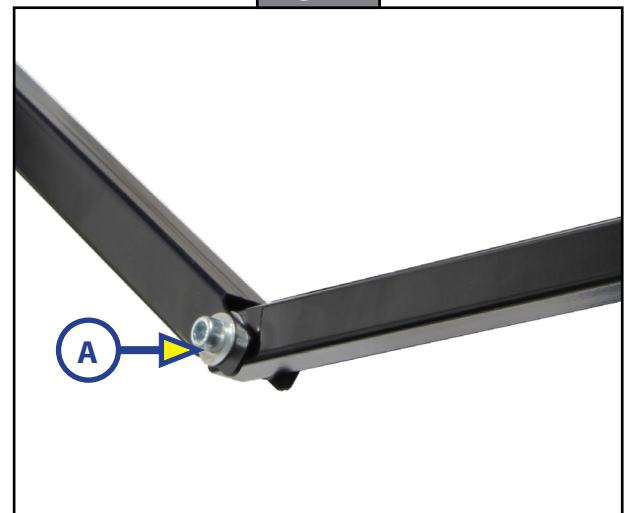

Maintenance

Fabric Care

If the awning is rolled up while wet, roll it out and let it dry as soon as conditions allow before rolling it up again. This will help prevent the formation of mildew and add greatly to the life of the awning.

NOTE: Mildew does not form on the fabric itself, but on the accumulated dust, dirt and grime.

Periodically clean vinyl or woven acrylic fabric using a mixture of $\frac{1}{4}$ cup of dish soap and five gallons of warm water.

1. Liberally slish the mixture on the top of the fabric and roll up the awning for five minutes.
2. Apply the mixture to the bottom of the fabric as well.
3. Roll the awning back out and hose off with fresh water.
4. Repeat if necessary.
5. Allow the fabric to dry before rolling up.

Troubleshooting

What's Happening?	Why?	What Should Be Done?
Awning won't open.	Locked	If optional travel locks are installed, make sure that they have been unlocked.
		Make sure cam lock is flipped to the extend position.
Awning pitch won't stay in the flat position.	Bad gas strut, incorrect pitch arm tension	Check for bad gas strut which will not allow awning to open all the way. The fabric will just drop down.
		Check pitch arm bolt for proper tension. (High winds can cause the pitch arm to deviate from the flat position due to the built-in safety feature of the awning.)
		Make sure all three washers are in the proper location of the pitch arm.
Awning doesn't close all the way.	Obstructions, fabric not square	The awning is considered completely closed as long as the outer arm is overlapping the mount arm. This overlap can vary.
		Make sure there are no obstructions in the support arm assemblies preventing the awning from closing.
		Verify the fabric is square from unit to roll tube and is rolling up straight on the roll tube.
Awning seems to wobble when extending or retracting.	Loose bolts, end caps not seated, bent shaft, mount arms not secured or bent, spacers not properly located	Make sure the bolts that hold the head to the support arm assemblies are tight.
		Make sure the end caps are seated properly on the roll tube.
		Make sure the shaft coming out of the head going to the end cap isn't bent.
		Make sure the mount arms are properly secured to the wall.
		Make sure no part of the support arm assemblies are bent.
		Make sure the wear collar spacers are all properly located in the support arm assemblies.
Awning will not stay in the rolled out position.	Faulty cam lock	<p>Check the cam lock. Signs of a faulty cam lock include:</p> <ul style="list-style-type: none"> • The absence of a clicking noise when the awning is rolled out. • The awning rolling back up after it is placed in the stop position.



SOLERA® MANUAL AWNING, PULL STRAP ASSEMBLY

AWNINGS

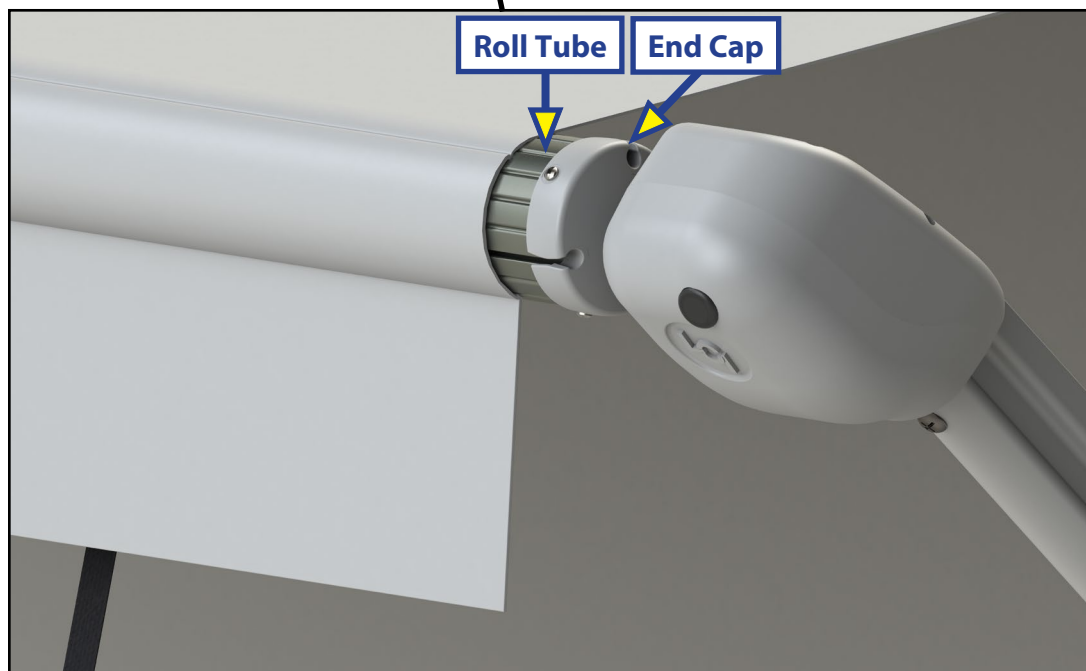
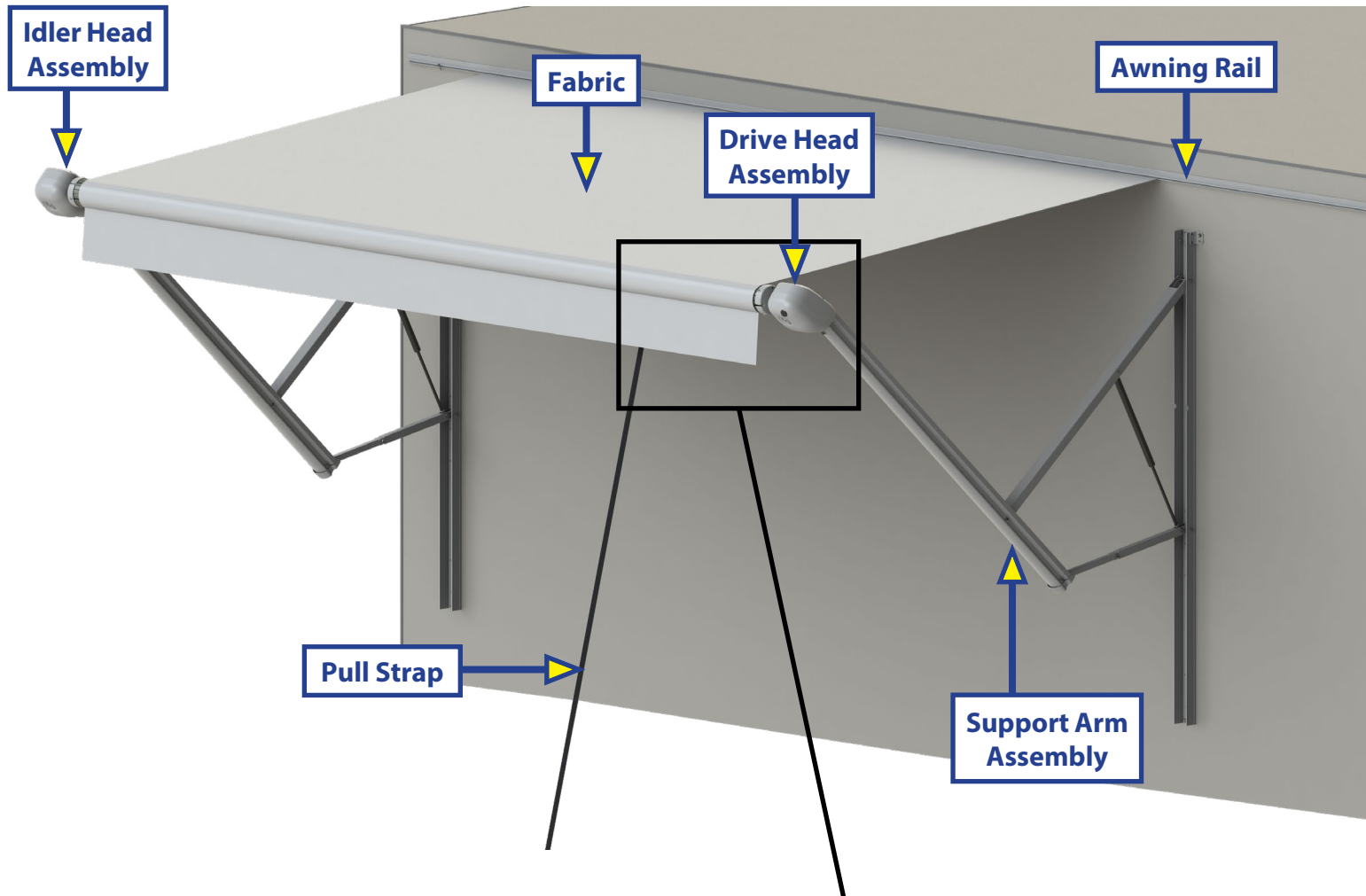

Awning Fabric and Roll Tube Replacement

To order replacement awning fabric and roll tube for your awning, locate the awning label on the roll tube. Locate the variant code at the bottom of the label. Call LCI Customer Service at 574-537-8900 and provide the variant code.



Callout	Part #	Description
A	272397	White Idler Head Assembly
	285147	Black Idler Head Assembly
B	266147	White Idler Head Assembly (Only used on 6' awning assemblies.)
	273479	Black Idler Head Assembly (Only used on 6' awning assemblies.)
C	289563	White Idler Head Front Cover
	289566	Black Idler Head Front Cover
D	289564	White Idler Head Rear Cover
	289567	Black Idler Head Rear Cover

AWNINGS

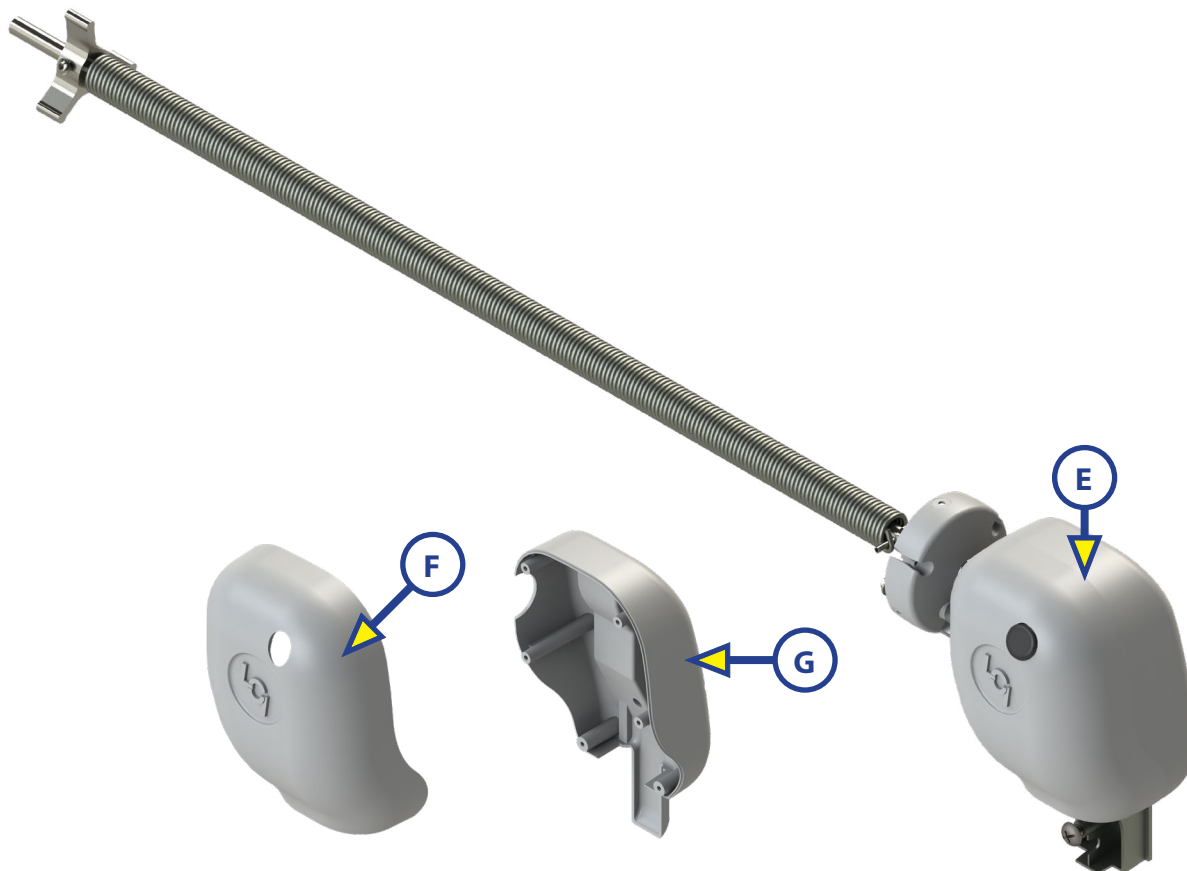

Callout	Part #	Description
E	271181	White Drive Head Assembly
	272067	Black Drive Head Assembly
F	289557	White Drive Head Front Cover
	289560	Black Drive Head Front Cover
G	289558	White Drive Head Rear Cover
	289561	Black Drive Head Rear Cover

AWNINGS

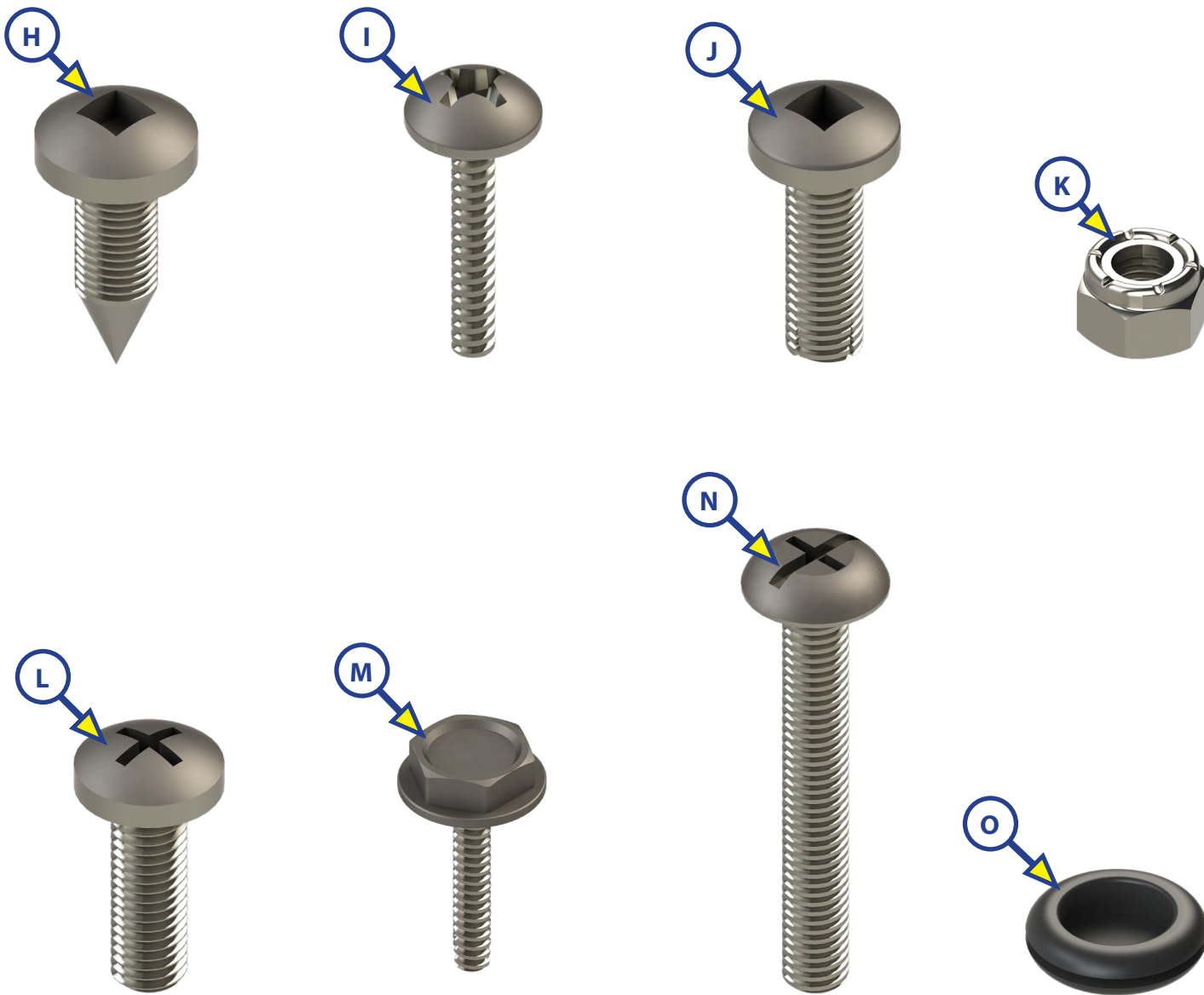

Callout	Part #	Description
H	299419	Screw #8 - 15 x 1/2 (End Cap to Roll Tube)
I	266156	#6 x 1/2 Screw (Fastener for Head Covers, 6 Per Cover)
J	299630	#8 End Cap Wax Screw (Head to Roll Tube)
K	118043	Nut 5/16 - 18 Nylon Lock (Head to Arm)
L	266155	Screw #8 - 32 x 1/2 (Back Cover to Mount)
M	281079	Screw #6 - 20 x 1/2
N	266148	Screw 5/16-18 x 2-1/4 (head to arm)
O	275071	Rubber Grommet (for manual override opening)

AWNINGS

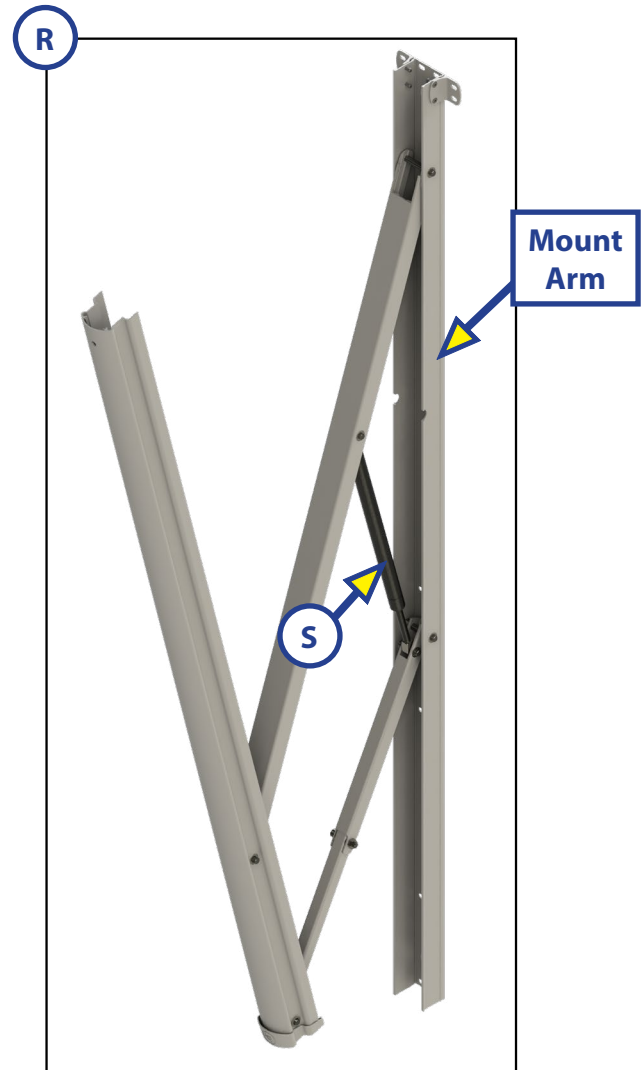
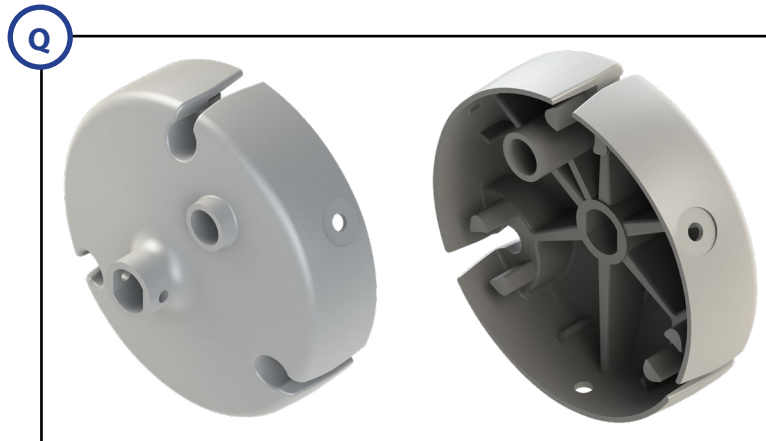
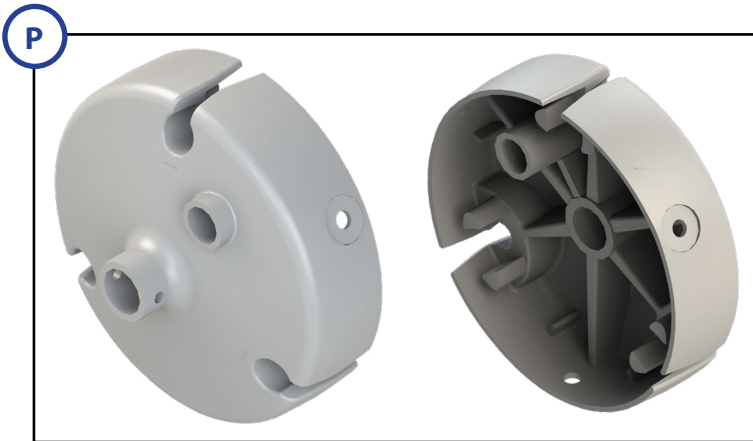

Callout	Part #	Description
P	3334291	White End Cap (Drive Head)
	3334292	Black End Cap (Drive Head)
Q	3334301	White End Cap (Idler Head)
	3334302	Black End Cap (Idler Head)
R	295742	White Support Arm Assembly (Short, 61 1/2")
	295743	Black Support Arm Assembly (Short, 61 1/2")
	260294	White Support Arm Assembly (Pitched, 66 1/8")
	266169	Black Support Arm Assembly (Pitched, 66 1/8")
	281152	White Support Arm Assembly (Flat, 69")
	281154	Black Support Arm Assembly (Flat, 69")
NOTE: Support Arm measurement based on wall mount extrusion.		
S	280343	Gas Strut; 61 1/2" Short, 69" Tall and 77" XL Awning Arms
	260282	Gas Strut; 63" Tall and 66 1/8" Tall Awning Arm
	346882	Gas Strut; 60 1/2" Tall Awning Arm

AWNINGS

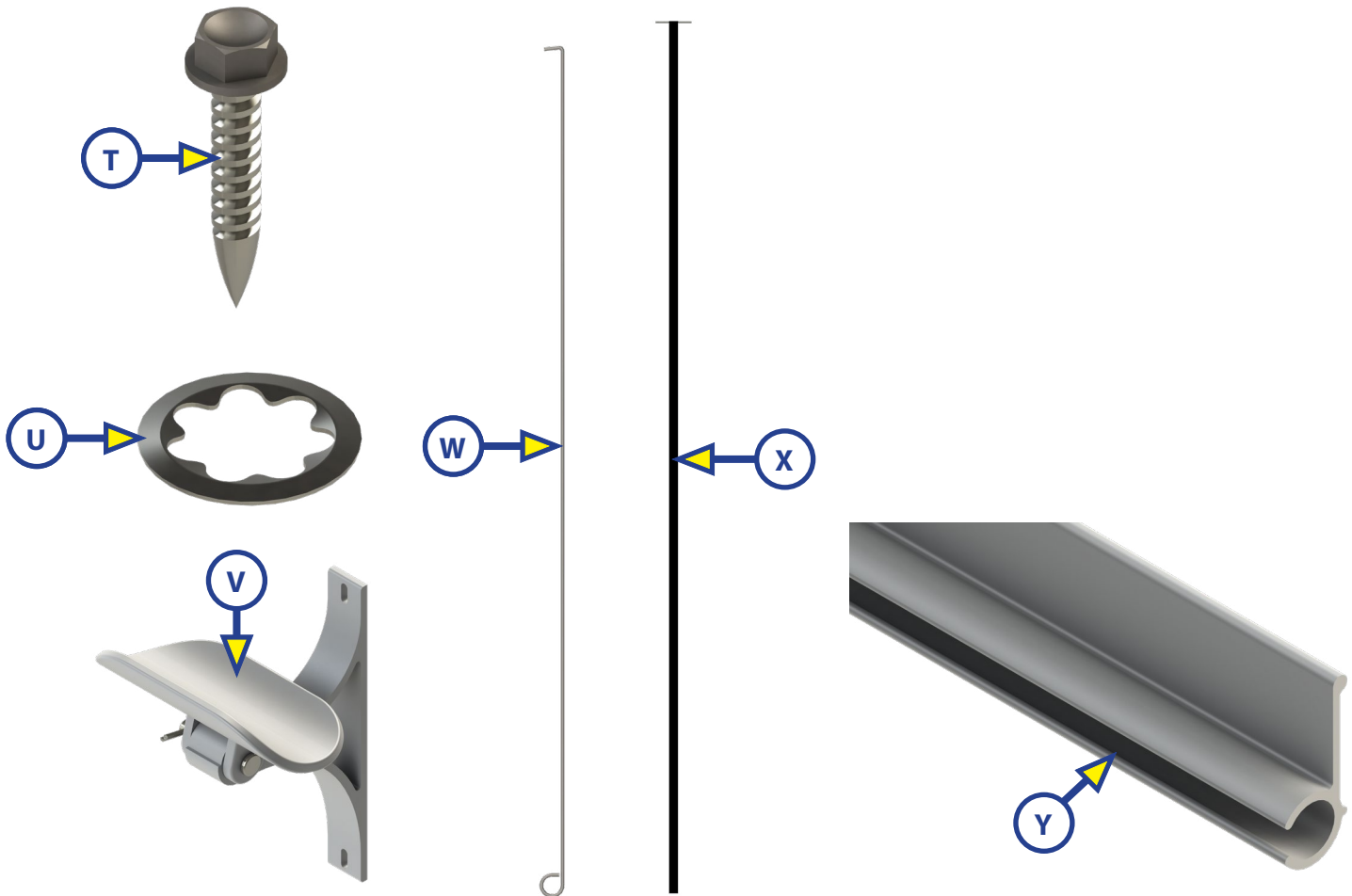

Callout	Part #	Description
T	286576	Screw #14 - 10 x 1 1/2 (Arms to Coach)
U	282484	Star Washer (for Gas Strut)
V	289373	White Awning Center Support Assembly
	289374	Black Awning Center Support Assembly
NOTE: Only required for Solera Awnings greater than 21' in length.		
W	344391	Pull Rod
X	292794	Manual Pull Strap Replacement
Y	281928	White Awning Rail (144")
	281929	Black Awning Rail (144")



L I P P E R T C O M P O N E N T S[®]

The contents of this manual are proprietary and copyright protected by Lippert Components, Inc. ("LCI"). LCI prohibits the copying or dissemination of portions of this manual unless prior written consent from an authorized LCI representative has been provided. Any unauthorized use shall void any applicable warranty. The information contained in this manual is subject to change without notice and at the sole discretion of LCI.

Revised editions are available for free download from www.lci1.com.

Please recycle all obsolete materials.

For all concerns or questions, please contact
Lippert Components, Inc.

Ph: (574) 537-8900 | Web: www.lci1.com | Email: customerservice@lci1.com